

## Your benefits with PPR® EFA Series filters for Compressed Air.

The PPR series EFA particle and oil filters and carbon adsorbers comply with the ISO 8753/1 requirements class 1 till 5 and offer an optimal and economical protection for compressed air applications. The pleated filter elements offer an optimal filtration degree at minimum pressure drop.

All the materials used have been lengthly tested with all kinds of compressor lubricants and are silicone-free. A specially designed element Snap-On system guarantees an ideal positioning and leak-tight sealing at element change-out.



Model 30 - 2500



Model 810 - 5265

- **Easy maintenance:** Snap-On element connection (model 30-2500)
- **Operational reliability:** high quality materials
- **Economical:** Low pressure drop due to pleating technology
- **Problem-free application:** oil resistant, silicone-free materials

Design specifications of EFA filters, models		SU	SU	AF	AC	30-120	180-1350	1800-2500	810-5265			
Medium	Compressed air	●	●	●	●	●	●	●	●			
Element saturation indicator	Pop-up indicator	■	■	■	▼	■	▼	▼	▼			
	Differential pressure gauge	■	■	■	▼	■	■	■	●			
	Differential pressure gauge with alarm contact"	■	■	■	▼	▼	■	■	■			
Housing	Aluminium casted	●	●	●	●	●	●	●	▼			
	Steel welded	▼	▼	▼	▼	▼	▼	▼	●			
Condensate discharge	automatic internal float drain	●	●	▼	▼	●	●	▼	▼			
	timer controlled drain valve	■	■	▼	▼	■	■	●	●			
	level controlled drain valve	■	■	▼	▼	■	■	■	■			
	manual drain	▼	▼	●	●	●	●	●	●			
Colour	Ral 9001 (white)	●	●	●	●	●	●	●	●			
Filtration efficiency	99,99% of particles 1 micron	●	▼	●	▼	●	●	●	●			
	99,999 of particles 0,01 micron	▼	●	▼	▼	●	●	●	●			
Residual oil content at 20°C	0,5 mgr/m <sup>3</sup>	●	▼	▼	▼	●	●	●	●			
	0,01 mgr/m <sup>3</sup>	▼	●	▼	▼	●	●	●	●			
	0,003 mgr/m <sup>3</sup>	▼	▼	▼	●	●	●	●	●			
Location	indoors	●	●	●	●	●	●	●	●			
IP rating	IP 65	●	●	●	●	●	●	●	●			
Vessel code	CE	●	●	●	●	●	●	●	●			
Design data		Minimum	Design	Maximum	SU	SU	AF	AC	30-120	180-1350	1800-2500	810-5265
Inlet pressure	2 bar (g)	7 bar (g)	16 bar (g)	●	●	●	●	●	●	●	13,5 bar (ü)	●
Ambient temperature	+2°C	+20°C	+55°C	●	●	●	●	●	●	●	●	●
Operation temperature	+2°C	+20°C	+65°C	●	●	●	●	●	●	●	●	●
	+2°C	+20°C	+80°C	■	●	■	▼	■	■	■	■	■

● standard | ■ optional | ▼ not applicable

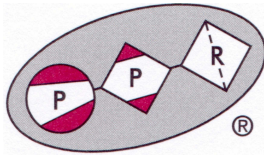

**PPR® SU filters** Filtration degree 1µ  
**PPR® SU filters** Filtration degree 0,01µ  
**PPR® AF filters** Filtration degree 1µ  
**PPR® AC filters** Remove:Oil vapour and odour

Model	Capacity 1 bar a. 20°C m³/h	Connection In- and outlet	drain	Dimensions (mm)						Weight		Filter element				Qty.	
				A	B			C		D	E	kg	SU	SU	AF		AC
				SU/SU	AF	AC	SU/SU AF	AC									
30	30	1/4"BSP	-	86	230	239	206	63	31	90	-	1.0	EFE30SU	EFE30SU	EFE30AF	EFE30AC	1
60	60	3/8"BSP	-	86	230	239	206	63	31	90	-	1.0	EFE60SU	EFE60SU	EFE60AF	EFE60AC	1
120	120	1/2"BSP	-	86	279	288	256	63	31	90	-	1.1	EFE120SU	EFE120SU	EFE120AF	EFE120AC	1
180	180	3/4"BSP	-	114	330	339	306	86	53	120	-	2.4	EFE180SU	EFE180SU	EFE180AF	EFE180AC	1
300	300	1"BSP	-	114	443	452	419	86	53	120	-	2.7	EFE300SU	EFE300SU	EFE300AF	EFE300AC	1
450	450	1/2"BSP	-	146	412	421	388	92	59	150	-	5.0	EFE450SU	EFE450SU	EFE450AF	EFE450AC	1
720	720	1/2"BSP	-	146	533	542	509	92	59	150	-	5.5	EFE720SU	EFE720SU	EFE720AF	EFE720AC	1
950	950	2"BSP	-	178	557	566	533	111	78	180	-	11.0	EFE950SU	EFE950SU	EFE950AF	EFE950AC	1
1350	1350	2"BSP	-	178	748	757	725	111	78	180	-	13.0	EFE1350SU	EFE1350SU	EFE1350AF	EFE1350AC	1
1800	1800	3"BSP	-	206	880	905	872	128	96	200	-	18.0	EFE1800SU	EFE1800SU	EFE1800AF	EFE1800AC	1
2500	2500	3"BSP	-	206	1007	1032	999	128	96	200	-	20.0	EFE2500SU	EFE2500SU	EFE2500AF	EFE2500AC	1
810	2700	DN100	3/8"	917		450		1084	324	800	55	8113 PFD	8113 HFDL	8113 DFD	8113 CFD	2	
1215	4050	DN100	3/8"	917		450		1084	324	800	90	8113 PFD	8113 HFDL	8113 DFD	8113 CFD	3	
1620	5400	DN150	3/8"	925		535		1183	324	800	105	8113 PFD	8113 HFDL	8113 DFD	8113 CFD	4	
2025	6750	DN150	3/8"	925		535		1183	324	800	105	8113 PFD	8113 HFDL	8113 DFD	8113 CFD	5	
2430	8100	DN150	3/8"	960		600		1184	400	800	123	8113 PFD	8113 HFDL	8113 DFD	8113 CFD	6	
3645	12150	DN200	3/8"	965		720		1302	500	800	235	8113 PFD	8113 HFDL	8113 DFD	8113 CFD	9	
5265	17550	DN250	3/8"	987		750		1387	550	800	239	8113 PFD	8113 HFDL	8113 DFD	8113 CFD	13	

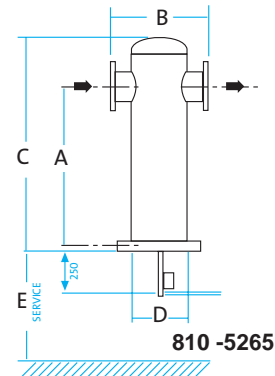
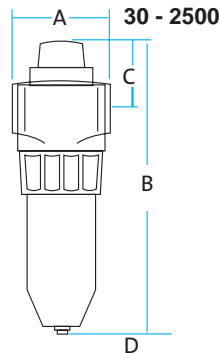

**Multiplier for different inlet pressures in bar (g)**

bar (g)	2	3	4	5	6	7	8	9	10	11	12	13	14	15	16
Multiplier 9 - 750	0.40	0.50	0.62	0.75	0.87	1.00	1.12	1.25	1.37	1.50	1.62	1.75	1.87	2.00	2.12
Multiplier 810 - 5265		0.71	0.79	0.87	0.93	1.00	1.06	1.12	1.17	1.22	1.27	1.31	1.37	1.41	1.46

Filterelement	SU	SU	AF	AC	
Initial pressure drop (dry)	0.03	0.08	0.03	0.03	bar (ü)
Initial pressure drop (wet)	0.14	0.19	-	-	bar (ü)
Element change-out at (the latest after 12 months)	0.40	0.40	0.40	500 hr.	bar (ü)
Color	green	blue	red	silver	bar (ü)

Subject to alterations without prior notice

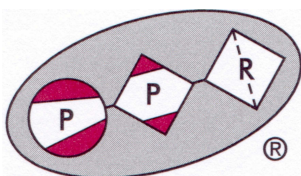

Pneumatic Products Raupach GmbH  
 Aschaffener Straße 5  
 D-64546 Mörfelden-Walldorf  
 Tel.-Nr.: 06105/71022  
 Fax.-Nr.: 06105/75458  
 E-Mail: [info@pneumatic-products.de](mailto:info@pneumatic-products.de)  
 Internet: [www.pneumatic-products.de](http://www.pneumatic-products.de)

